

HYUNDAI
POWER PRODUCTS

ELECTRIC LAWN MOWER

HTDE511RP

ORIGINAL INSTRUCTIONS



WARNING: Read thoroughly the instruction manual before use.

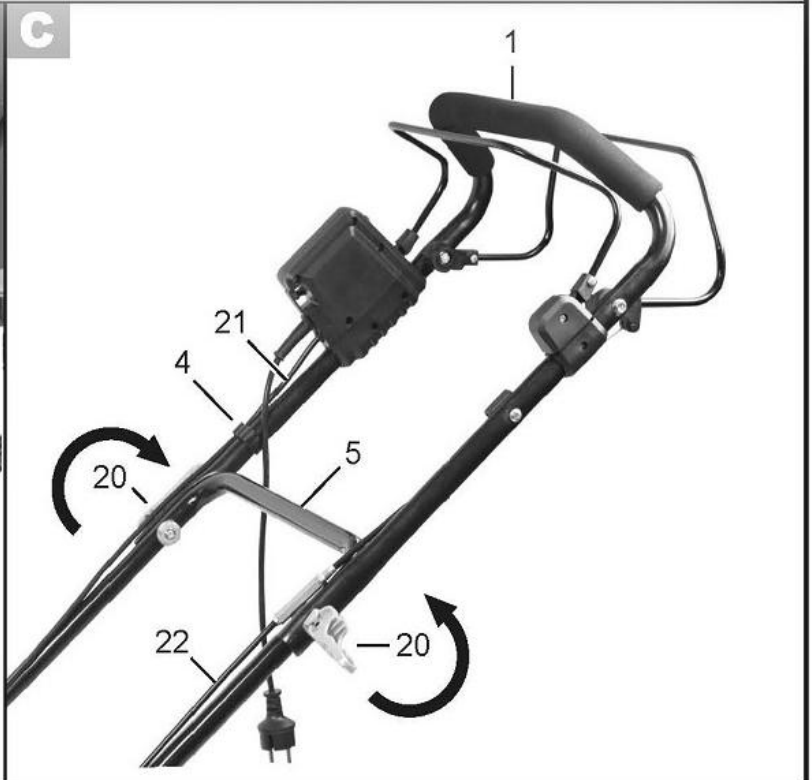
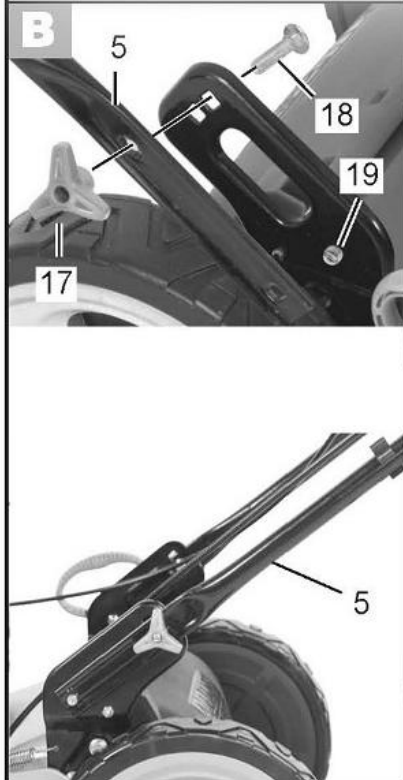
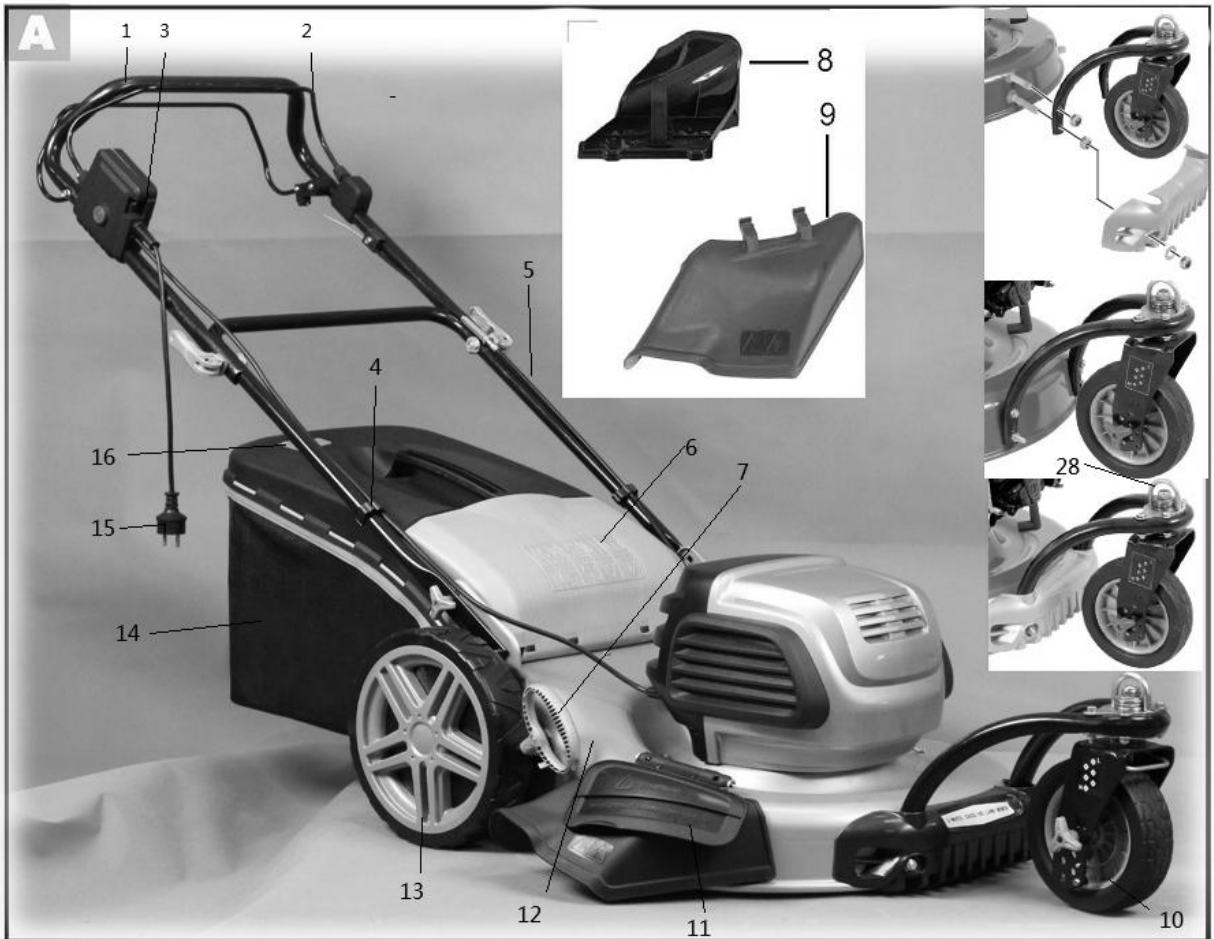

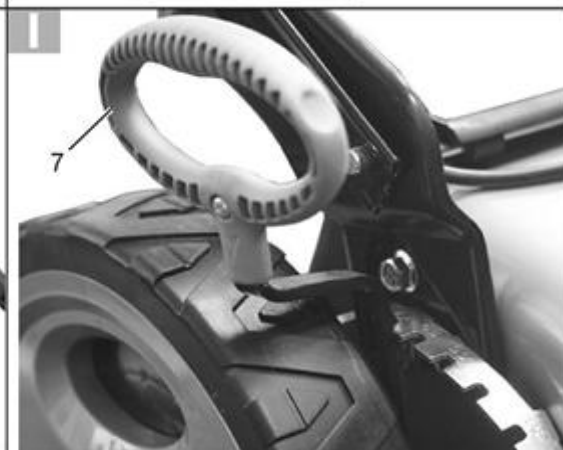
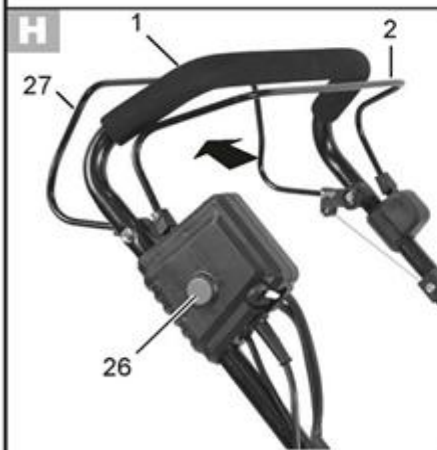
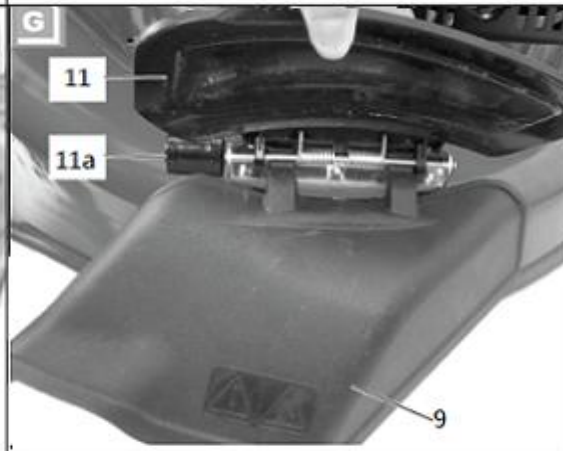
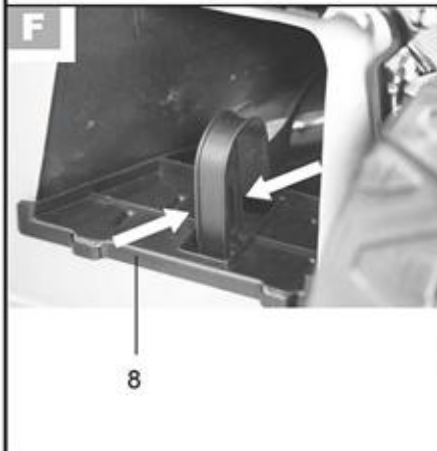
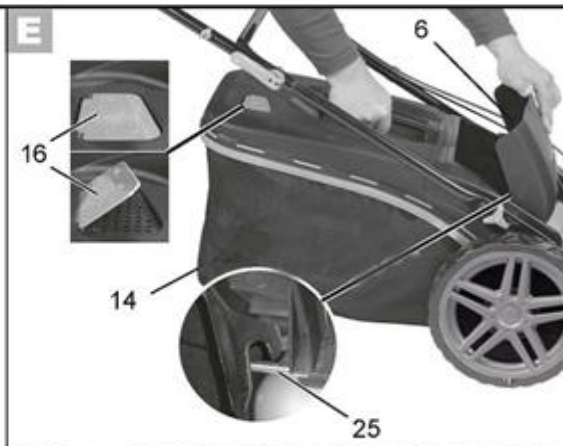

SAFETY INSTRUCTIONS

IMPORTANT READ CAREFULLY BEFORE USE KEEP FOR FUTURE REFERENCE

Safe operating practices for electrically powered lawnmowers

Training

- a) Read the instructions carefully. Be familiar with the controls and the correct use of the machine.
- b) Never allow children or people unfamiliar with these instructions to use the machine. Local regulations can restrict the age of the operator.
- c) Never operate the machine while people, especially children, or pets are nearby.
- d) Keep in mind that the operator or user is responsible for accidents or hazards occurring to other people or their property.

Preparation

- a) While operating the machine always wear substantial footwear and long trousers. Do not operate the machine when barefoot or wearing open sandals. Avoid wearing clothing that is loose fitting or that has hanging cords or ties.

b) Thoroughly inspect the area where the machine is to be used and remove all objects which can be thrown by the machine.

c) Before using, always visually inspect to see that the blade, blade bolt and the blade assembly are not worn or damaged. Replace worn or damaged components in sets to preserve balance. Replace damaged or unreadable labels.

d) Before use check the supply and extension cord for signs of damage or aging. If the cord becomes damaged during use, disconnect the cord from the supply immediately. **DO NOT TOUCH THE CORD BEFORE DISCONNECTING THE SUPPLY.** Do not use the machine if the cord is damaged or worn.

Operation

a) Operate the machine only in daylight or in good artificial light.

b) Avoid operating the machine in wet grass.

c) Always be sure of your footing on slopes.

d) Walk, never run.

e) Mow across the face of slopes, never up and down.

f) Exercise extreme caution when changing direction on slopes.

g) Do not mow excessively steep slopes.

h) Use extreme caution when reversing or pulling the machine towards you.

- i) Stop the blade(s) if the machine has to be tilted for transportation when crossing surfaces other than grass, and when transporting the machine to and from the area to be used.
- j) Never operate the machine with defective guards or shields, or without safety devices, for example deflectors and/or grass collector, in place.
- k) Switch on the motor carefully according to instructions and with feet well away from the blade(s).
- l) Do not tilt the machine when switching on the motor, except if the machine has to be tilted for starting. In this case, do not tilt it more than absolutely necessary and lift only the part, which is away from the operator.
- m) Do not start the machine when standing in front of the discharge opening.
- n) Do not put hands or feet near or under rotating parts. Keep clear of the discharge opening at all times.
- o) Do not transport the machine while the power source is running.
- p) Stop the machine, and remove plug from the socket. Make sure that all moving parts have come to a complete stop:
 - whenever you leave the machine,
 - before clearing blockages or unclogging chute,

- before checking, cleaning or working on the machine,
- after striking a foreign object.

Inspect the machine for damage and make repairs before restarting and operating the machine;

If the machine starts to vibrate abnormally (check immediately):

- inspect for damage,
- replace or repair any damaged parts,
- check for and tighten any loose parts.

Maintenance and storage

a) Keep all nuts, bolts and screws tight to be sure the machine is in safe working condition.

b) Check the grass collector frequently for wear or deterioration.

d) On machines with multi blade, take care as rotating one blade can cause other blades to rotate

e) Be careful during adjustment of the machine to prevent entrapment of the fingers between moving blades and fixed parts of the machine.

Recommendation for class II machine

The machine should be supplied via a residual current device (RCD) with a tripping current of not more than 30 mA

Additional instructions

- Do not use this tool in wet weather.
- Do not use the tool in bad weather conditions (rain, thunderstorms, storms, etc.).
- The handling / connection of the cables must be dry.
- Always avoid contact between an electrical outlet or cable and a wet area (puddle or wet grass).
- The connections between the cables and the plugs must be sealed. Use extension cords only with commercially available waterproof plugs or standards.
- The power supply cables must not be of a quality inferior to type H05RN-F. H05RR-f.H05WF.H05VVH2-F. for outdoor use, with a minimum section of 1.5 m².
- Secure the cable to the hook before turning on the equipment.
- The permanent connection of any electrical device in a building must be done by a qualified electrician in accordance with the electrical standards in force.
- An incorrect connection can cause serious injury or death.
- Before connecting the appliance, check that the plugs and extension cords are in good condition. Do not use the appliance if the appliance is damaged or worn.

- Never use the appliance if the guards are defective or without safety devices, for example the grass catcher in place.
- Use only an extension cord attached to a coupler according to the IEC 60320-2-3 standard.
- Always direct the cable away from the device.
- Mow by day or under adequate artificial light.
- Avoid operating the unit in wet grass or in the rain.
- Never ride the power cable with the lawn mower.
- When mowing, the cable should always be behind the mower and in the area where grass has already been cut.
- Use the cable hook to prevent unexpected disconnection of the cable.
- Make sure the plug is inserted correctly and do not force the plug.
- Never pull the lawn mower by its power cable, and never pull the cable out of the socket.
- Do not expose the cable to sources of heat. Do not allow it to come into contact with solvents, oil, fuels, or smudged objects.
- If a cable is damaged during use, disconnect the plug immediately. **DO NOT TOUCH THE CABLE BEFORE DISCONNECTING THE SOCKET.**
- Unplug the unit from the power sources:
 - Whenever you leave the device

- Before solving a problem.
 - Before checking, cleaning or working on the unit.
 - If the unit starts to vibrate abnormally
- Always ensure your position on the slopes.
 - Mow facing slopes, never up and down.
 - Be extremely careful when changing direction on slopes.
 - Do not mow on slopes of more than 20 °.
 - Walk, never run, do not get pulled by the lawn mower.
 - Be extremely careful when pulling the lawn mower toward you.
 - Stop the engine if you must tilt the lawnmower for transport, when crossing areas other than grass, and when transporting it to another area to be mowed.
 - Never operate the lawn mower with defective protections, or without a safety device, such as a deflector or grass catcher that is not in place.
 - Start the engine with the switch on, cautiously as instructed, and feet well away from the blade.
 - Do not tilt the mower when starting the engine.
 - Start the engine on a flat surface with no obstacles or grass too high.
 - Do not put your hands or feet under rotating parts.

- When working on the grass catcher or on the ejection duct, stop the engine.
- Never lift or carry a lawnmower with the engine running.
- When mowing, always keep a safe distance from the rotating blade. This distance is the length of the handlebars.
- After a breakdown, stop the engine immediately, do not continue mowing, take the machine to an authorized service center and ask qualified personnel to eliminate the problem.
- If the supply cord is damaged, it must be replaced by the manufacturer, its service agent or similarly qualified persons in order to avoid a hazard.

Residual risks

Even if you use this product in compliance with all safety requirements, the potential risks of injury and damage remain. The following hazards may arise in the structure and design of this product.

- There are adverse health consequences resulting from the emission of vibration if the product is used for long periods of time or not properly managed and properly maintained.
- There are risks of injury and property damage due to attachments or broken the sudden impact of hidden objects when using cutting.

- Risk of injury to persons and property caused by flying objects.
- Prolonged use of this product exposes the operator to vibrations and can produce so-called "white finger" disease. To reduce the risk, wear gloves and keep your hands warm. If any of the symptoms of "white finger syndrome" occur, seek immediate medical attention. Symptoms of "white finger" include numbness, loss of sensitivity, tingling, tingling, and pain, loss of strength, color changes or skin condition. These symptoms usually appear on the fingers, hands or wrists. Risk increases at low temperatures.
- There is a risk of loss hearing in case of prolonged use and when a hearing protection is not worn.

Intended use

This lawnmower is designed for natural grass mowing. Any other use is prohibited.

It is suitable only for private use in a garden or plot. Lawnmowers designed for private plots or gardens are those used for the maintenance of grassy areas and private lawns and should not be used in public areas, parks, sports, agricultural or forest areas.

Symbols



Read instructions manual



Risk of projections; Keep bystanders away



Beware of sharp blades. Blades continue to rotate after the motor is switched off – Remove plug from mains before maintenance or if cord is damaged.”



Risk of electrical shock - “Keep supply flexible cord away from cutting means”



Wear hearing and ocular protection. Do not use the tool under rain



Warning! Rotating blades – the blades must be to a complete stop before manipulation



Guarantee sound power level

Technical data

Type	HTDE511RP
guaranteed sound power level	98 dB(A)
Power	1800W
Voltage	230-240V~
No load speed	2900/min
Working width	51cm
Weight	32kg
Vibration value	Left handle: 1.851 m/s ² K=1.5 m/s ² Right handle: 1.296 m/s ² K=1.5 m/s ²
Sound pressure level	84.9 dB(A) K= 3dB

DESCRIPTION

See pages 2-4

- | | |
|---------------------------------------|------------------------------------|
| 1 Bow-type handle | 16 level gauge indicator |
| 2 Safety bracket | 17 Star grip nut |
| 3 Cable strain relief | 18 Screw for bar attachment |
| 4 Cable clamp | 19 Screw on device housing |
| 5 Lower bar | 20 Clamping lever |
| 6 Flap | 21 Device cable |
| 7 Lever for cutting height adjustment | 22 Bowden cable |
| 8 Mulching kit | 23 Plastic straps - collection bag |
| 9 Side discharge | 24 Collection bag rod |
| 10 Front wheels | 25 Collection bag attachment |
| 11 Side discharge protection | 26 Release button |
| 12 Machine housing | 27 Drive bracket |
| 13 Rear wheels | 28 Clamping bracket |
| 14 Collection bag | 29 Blade |
| 15 Power plug | 30 Blade bolt |

ASSEMBLY

Caution! Risk of injury from rotating blades. Carry out work on the equipment only when the blade is switched off and stationary. Disconnect the plug before any work on the equipment.

Mount the front wheel

1. From the back, insert the screws through the openings (the longer screws must be fitted into the lower hole) and fasten the rods of the front wheel with the nuts.
2. Fasten the cladding on to the lower, still protruding screws.

Install lower bar (Fig. B)

1. Place the holes on the lower bar (5) over the screws (19) at the right and left of the device housing.
2. Tightly screw in the bar (5) with a screw on each side (18) and a star grip nut (17).

Install curved handle (Fig. C)

1. Tilt the bow-type handle (1) into position.
2. Turn the clamping levers (20) clockwise.
3. Lock the clamping levers (20) by pushing them towards the bar (5). Clamping levers to be tightened and contacting the bar such that they clamp at average force. Otherwise you may have to tighten (turn clockwise) or loosen them (turn anticlockwise).

Clip on the cable hook:

Clip the cable holders (4) onto the bar (5) and bow-type handle (1) in order to secure the device cable (21) and Bowden cable (22).

Install/empty grass catcher (Fig D&E)

Caution: Use the equipment when the grass catcher is completely and properly installed.

The mulching kit and side discharge should not be installed on the machine when the grass catcher is to be installed.

Assemble grass catchment basket (14):
Pull plastic loops (23) over basket rods (24).

Fixing the grass catcher

The mulch kit and lateral discharge must be removed prior to using the collection bag.

1. Lift up shock protection (6).
2. Hook the grass collection box (14) into the mounting provided for this (25) on the rear of the equipment.
3. Release the flap (6).

Dismantling/Empty out the Grass Collection Box

4. Lift the impact protection (6) and remove the grass collection box (14)
5. Empty catchment basket and re-install it.

Level gauge (fig. E)

The level gauge (E 16) is located on the side of the grass catcher (E 14). The aerodynamic air guidance provided by the flap also optimizes the filling.

GO Flap open: grass catcher empty

STOP Flap closed: grass catcher full

Attaching mulching kit (fig. F)

Prior to using the mulch kit, the lateral ejection canal has to be removed.

1. Remove the grass catcher, if installed.
2. Lift the flap.

3. Insert the mulch kit (8).

Remove mulch kit

4. Lift the flap.

5. Release the mulch kit (8) by pressing together the double grips and then remove it.

Side discharge (Fig G)

Before using the lateral grass ejection, the mulching kit and grass catcher shall be removed.

1. Unlock the side discharge protection (11) by pulling the locking element (11a) to the left and opening the lateral impact protection (11).

2. Mount the side discharge (9) on the hook.

Adjusting the cutting height (Fig.I)

Switch off the equipment, disconnect the plug and wait for the blade to stop. There is a risk of injury.

The equipment has 6 positions for setting the cutting height (25-75 mm):

1. Pull the lever (7) outwards and push it to the desired position.

2. Push the lever back in.

3. Also set the appropriate height on the front wheel.

The label on the wheel mounting shows the associated settings for the cutting height associated settings.

Loosen the wing nut and fasten the wheel in the desired position.

4. The alignment of the wheel is fixed once the clamping brackets (28) snap into place. If the wheel is desired in another running direction, lift clamping bracket to release it. Bring wheel into new position and clamping brackets snaps into place once again.

Adjust front wheels

The lawn mower is extremely flexible and maneuverable thanks to the special construction of the front wheels.

These are to be adjusted according to the specific situation as follows:

1. The alignment of the wheel is fixed once the clamping brackets (28) snap into place. If the wheel is desired in another running direction, lift clamping bracket to release it. Bring wheel into new position and clamping brackets snaps into place once again.

2. Should the front wheels remain able to move freely, lift the clamping brackets (28) and do not place them in the opening, but rather set them on the plate beside it.

Switching On and Off

The red light above the release button will illuminate as soon as the lawn mower is connected to a power supply.

1. Connect the mains plug (A15) to the extension cable.

2. Make a loop in the end of the extension cable and suspend this in the cable strain relief (3).

3. Connect the equipment to the power supply.

4. Before switching on, ensure that the equipment is not in contact with any objects.

5. To switch on, press and hold the release button (26) on the hand grip and pull the safety bracket (2) towards the bow-type handle (1).

Release the release button (26).

6. Wheel drive:

On: Pull the drive catch (27) towards the handle bar. The mower moves forwards.

Off: Release the drive catch (27) the equipment stops.

7. To switch off, release the safety bracket (2).

OPERATION

Note: Use a residual current device (RCD) rated for a residual current not greater than 30 mA.
Important! The front and back wheels must be set to the same height.



Starting and Stopping

The blade continues to rotate for a few seconds after the machine is switched off. Allow the motor/blade to stop rotating before switching “on” again. Do not rapidly switch off and on.

Starting:

1. Press and hold the safety button.
2. Squeeze the switch lever towards the handle.
3. Release the safety button.

Stopping:

Release the switch lever.

Mowing:

Position the cable to opposite side (already cut) at the end of each turn.

When mowing, do not allow the motor to labor particularly in heavy conditions. When the motor labors the speed of the motor drops and you will hear a change in the motor sound, when this occurs stop mowing, release the switch lever and raise the height of cut. Failure to do so could damage the machine.

MAINTENANCE

Cleaning



Note: Disconnect electricity by unplugging cable at the socket before proceeding. Attention: keep hands clear of moving blade.

Clean mower thoroughly after each mowing with cloth or brush.

Do not spray with water.

Winter storage

- Clean mower thoroughly before storing away.
- Have your mower thoroughly checked once a year by an approved service center
- **Do not store it in a wet or humid place.**
- Keep all nuts, bolts, and screws tight to be sure the appliance is in safe working condition.
- Check the grass catcher frequently for wear or deterioration.
- Replace worn or damaged parts for safety.

Change of cutter blade



Stop, remove plug from the power supply and remove the collector.

If the blade is blunt, it can be sharpened by a specialist workshop. If the blade is damaged or showing signs of imbalance, it must be replaced.

1. Turn the equipment over.
2. Use sturdy gloves and hold the blade firmly (29). Use a spanner to turn the blade bolt (30) counter-clockwise from the motor spindle.
3. Install the new blade in the reverse order. Ensure that the blade is positioned correctly and the screw tightened firmly.

DISPOSAL



Electrical products should not be discarded with household products. According to the European Directive 2012/19/EU on waste electrical and electronic equipment and its implementation into national law, electrical products used must be collected separately and disposed of at collection points provided for this purpose. Talk with your local authorities or dealer for advice on recycling.

GB / DECLARATION OF CONFORMITY



BUILDER SAS

ZI, 32 rue Aristide Bergès – 31270 Cugnaux - France

Tel: +33 (0)5.34.502.502 Fax: +33 (0)5.34.502.503

Declares that the machines:

ELECTRIC LAWN MOWER

Model: HTDE511RP

Serial No: 20220115607-20220115756

Responsible of the technical file: Mr. Olivier Patriarca

have been designed in compliance with the following standards:

EN 55014-1:2006+A1+A2

EN 55014-2:2015

EN 61000-3-11:2000

EN 61000-3-2:2014

EN 60335-1: 2012+A11+A13+A1+A14+A2

EN 60335-2-77: 2010

EN 62233: 2008

And in accordance with the following directives:

Directive Machine 2006/42/EC

Directive EMC 2014/30/EU

Rohs Directive (EU)2015/863 amending 2011/65/EU

Noise Directive 2000/14/EC Annex VI & Directive 2005/88/EC

Guaranteed sound power level	98 dB(A)
------------------------------	----------

Notified body

Société Nationale de Certification et d'Homologation NB 0499

11, route de Luxembourg L-5230 Sandweiler

Philippe MARIE / PDG
Cugnaux, **12-10-2021**

WARRANTY

HYUNDAI

WARRANTY

The manufacturer guarantees the product against defects in material and workmanship for a period of 2 years from the date of the original purchase. The warranty only applies if the product is for household use. The warranty does not cover breakdowns due to normal wear and tear.

The manufacturer agrees to replace parts identified as defective by the designated distributor. The manufacturer does not accept responsibility for the replacement of the machine, in whole or in part, and/or ensuing damage.

The warranty does not cover breakdowns due to:

- insufficient maintenance.
- abnormal assembly, adjustment or operations of the product.
- parts subject to normal wear and tear.

The warranty does not extend to:

- shipping and packaging costs.
- using the tool for a purpose other than that for which it was designed.
- the use and maintenance of the machine done in a manner not described in the user manual.

Due to our policy of continuous product improvement, we reserve the right to alter or change specifications without notice. Consequently, the product may be different from the information contained therein, but a modification will be undertaken without notice if it is recognized as an improvement of the preceding characteristic.

READ THE MANUAL CAREFULLY BEFORE USING THE MACHINE.

When ordering spare parts, please indicate the part number or code, you can find this in the spare parts list in this manual. Keep the purchase receipt; without it, the warranty is invalid. To help you with your product, we invite you to contact us by phone or via our website:

- **+33 (0)9.70.75.30.30**
- **<https://services.swap-europe.com/contact>**

You must create a "ticket" via the web platform.

- Register or create your account.
- Indicate the reference of the tool.
- Choose the subject of your request.
- Describe your problem.
- Attach these files: invoice or sales receipt, photo of the identification plate (serial number), photo of the part you need (for example: pins on the transformer plug which are broken).



PRODUCT FAILURE

WHAT TO DO IF MY MACHINE BREAKS DOWN?

If you bought your product in a store:

- a) Empty the fuel tank if your product has one.
- b) Make sure that your machine is complete with all accessories supplied, and clean! If this is not the case, the repairer will refuse the machine.

Go to the store with the complete machine and with the receipt or invoice.

If you bought your product on a website:

- a) Empty the fuel tank if your product has one..
- b) Make sure that your machine is complete with all accessories supplied, and clean! If this is not the case, the repairer will refuse the machine.
- c) Create a SWAP-Europe service ticket on the site: <https://services.swap-europe.com> When making the request on SWAP-Europe, you must attach the invoice and the photo of the nameplate (serial number).
- d) Contact the repair station to make sure it is available before dropping off the machine.

Go to the repair station with the complete machine packed, accompanied by the purchase invoice and the station support sheet downloadable after the service request is completed on the SWAP-Europe site

For machines with engine failure from manufacturers BRIGGS & STRATTON, HONDA and RATO, please refer to the following instructions.

Repairs will be done by approved engine manufacturers of these manufacturers, see their site:

- <http://www.briggsandstratton.com/eu/fr>
- <http://www.honda-engines-eu.com/fr/service-network-page;jsessionid=5EE8456CF39CD572AA2AEEDFD290CDAE>
- <https://www.rato-europe.com/it/service-network>

Please keep your original packaging to allow for after-sales service returns or pack your machine with a similar cardboard box of the same dimensions.

For any question concerning our after-sales service you can make a request on our website <https://services.swap-europe.com>

Our hotline remains available at +33 (9) 70 75 30 30.



WARRANTY EXCLUSIONS

THE WARRANTY DOES NOT COVER:

- Start-up and setting up of the product.
- Damage resulting from normal wear and tear of the product.
- Damage resulting from improper use of the product.
- Damage resulting from assembly or start-up not in accordance with the user manual.
- Breakdowns related to carburetion beyond 90 days and fouling of carburetors.
- Periodic and standard maintenance events.
- Actions of modification and dismantling that directly void the warranty.
- Products whose original authentication marking (brand, serial number) has been degraded, altered or withdrawn.
- Replacement of consumables.
- The use of non-original parts.
- Breakage of parts following impacts or projections.
- Accessories breakdowns.
- Defects and their consequences linked to any external cause.
- Loss of components and loss due to insufficient screwing.
- Cutting components and any damage related to the loosening of parts.
- Overload or overheating.
- Poor power supply quality: faulty voltage, voltage error, etc.
- Damages resulting from the deprivation of enjoyment of the product during the time necessary for repairs and more generally the costs related to the immobilization of the product.
- The costs of a second opinion established by a third party following an estimate by a SWAP-Europe repair station
- The use of a product which would show a defect or a breakage which was not the subject of an immediate report and/or repair with the services of SWAP-Europe.
- Deterioration linked to transport and storage*.
- Launchers beyond 90 days.
- Oil, petrol, grease.
- Damages related to the use of non-compliant fuels or lubricants.

* In accordance with transport legislation, damage related to transport must be declared to carriers within 48 hours maximum after observation by registered letter with acknowledgement of receipt.

This document is a supplement to your notice, a non-exhaustive list.

Attention: all orders must be checked in the presence of the delivery person. In case of refusal by the delivery person, it you must simply refuse the delivery and notify your refusal.

Reminder: the reserves do not exclude the notification by registered letter with acknowledgement within 72 hours.

Information:

Thermal devices must be wintered each season (service available on the SWAP-Europe site). Batteries must be charged before being stored.

HYUNDAI
POWER PRODUCTS

For Inquiries, please contact:

BUILDER SAS

32, Rue Aristide Bergès Z1 31270 Cugnaux, France

Tél.: +33(0)5.34.502.502 Fax : +33(0)5.34.502.503

<http://www.hyundaipower-fr.com/>

Fabriqué en République Populaire de Chine(PRC)